

PT10SR-2388 Piezoresistive Pressure Transducer

Features

- Laser trimming compensating zero and FS thermal error;
- Used for non-conductive and non-corrosive liquid or gas;
- Optional constructions;
- Compact size, easy installation;
- Gauge, absolute and sealed gauge;
- Constant current supply;



Introduction

PT10SR-2388 pressure transducer is produced by build-in a piezoresistive pressure sensor into stainless steel housing with pressure ports. The measured pressure acts on silicon die through pressure port, transmitting pressure into voltage output signal by linearity relationship. Laser trimming hybrid compensates transducer zero, span and so on, the product is widely used for pressure calibration device, automobile, aviation, spaceflight, air pressure control and industrial measure, especially for transducer with pressure port HB4-3, it has been widely used for aviation industry.

Outline Construction

(Unit: mm)

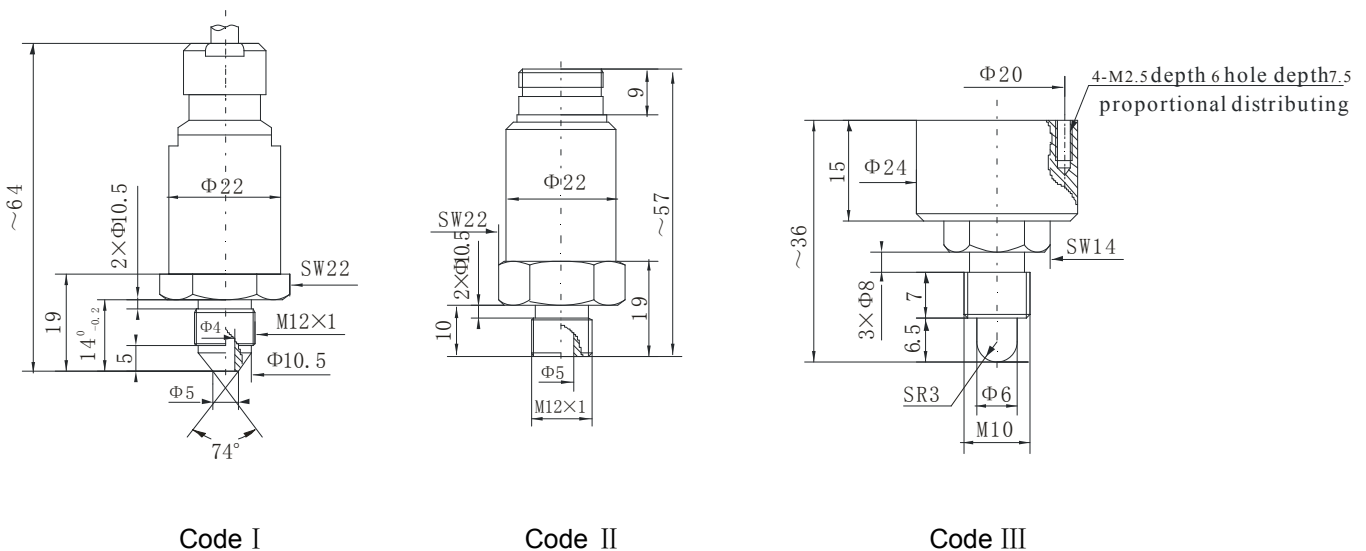

Specification

@1.5mADC, 25°C		
Pressure range	0~20kPa...7MPa	
Power supply	1.5mADC	
Overpressure	1.5 times FS	
Zero output	±2 mVDC	
FS output	≥50mVDC	
Non-linearity	±0.25%FS (typ.)	±0.50%FS (max.)
Repeatability	±0.05%FS (typ.)	±0.10%FS (max.)
Hysteresis	±0.05%FS (typ.)	±0.10%FS (max.)
Zero temp. coefficient	±1.0%FS/°C (typ.)	±2.0%FS/°C (max.)
FS temp. coefficient	±1.0%FS/°C (typ.)	±2.0%FS/°C (max.)
Compensation temp.	0°C~50°C	
Operation temp.	-40°C~120°C	
Long-term stability	±0.2%FS/year (typ.)	±0.3%FS/year (max.)

Electric Connection

Code I		Code II			Code III	
Color	Connection	Pin	Color	Connection	Pin	Connection
Black	(+IN)	1	Black	(+IN)	4	(+OUT)
Red	(+OUT)	2	Red	(+OUT)	5	(+IN)
Blue	(-OUT)	3	Blue	(-OUT)	6	(-IN)
White	(-IN)	4	White(yellow)	(-IN)	10	(-OUT)
Yellow	(-IN)					

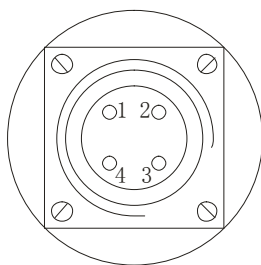

Code II

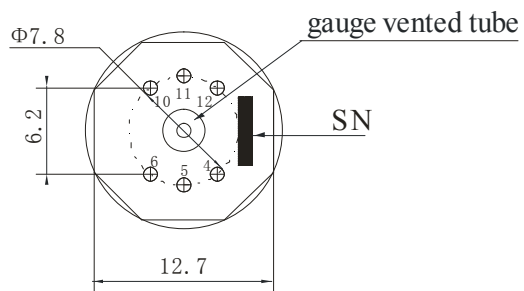

Code III

Order guide

PT10SR-2388		Piezoresistive Pressure Transducer				
Code	Pressure range	Ref.	Code	Pressure range	Ref.	
0B	0~20kPa	G	09	0~700kPa	G、A	
0A	0~35kPa	G	10	0~1.0MPa	G、A	
02	0~70kPa	G、A	12	0~2.0MPa	G、A	
03	0~100kPa	G、A	13	0~3.5MPa	G、A、S	
07	0~200kPa	G、A	14	0~7.0MPa	S、A、S	
08	0~350kPa	G、A				
	Code	Pressure type				
	G	Gauge				
	A	Absolute				
	S	Sealed gauge				
	Code	Power supply				
	L	Constant current supply				
	Code	Pressure port (customized ports are also optional)				
	I	M12×1 male (HB4-3), Code I (with 1.5m cable)				
	II	M12×1 male (flat head), Code II (plug connection)				
	III	M10 male (ball head), Code III (Φ0.45 Kovar)				
PT10SR-2388	08	G	L	I	the whole spec	

Order Note

1. 1.5m cable is free of charge; the extra cable should be paid additionally;
2. For your special use or requirements, please contact with our company freely.